

Technische Dokumentation Technical documentation
drylin®

DELTA ROBOT

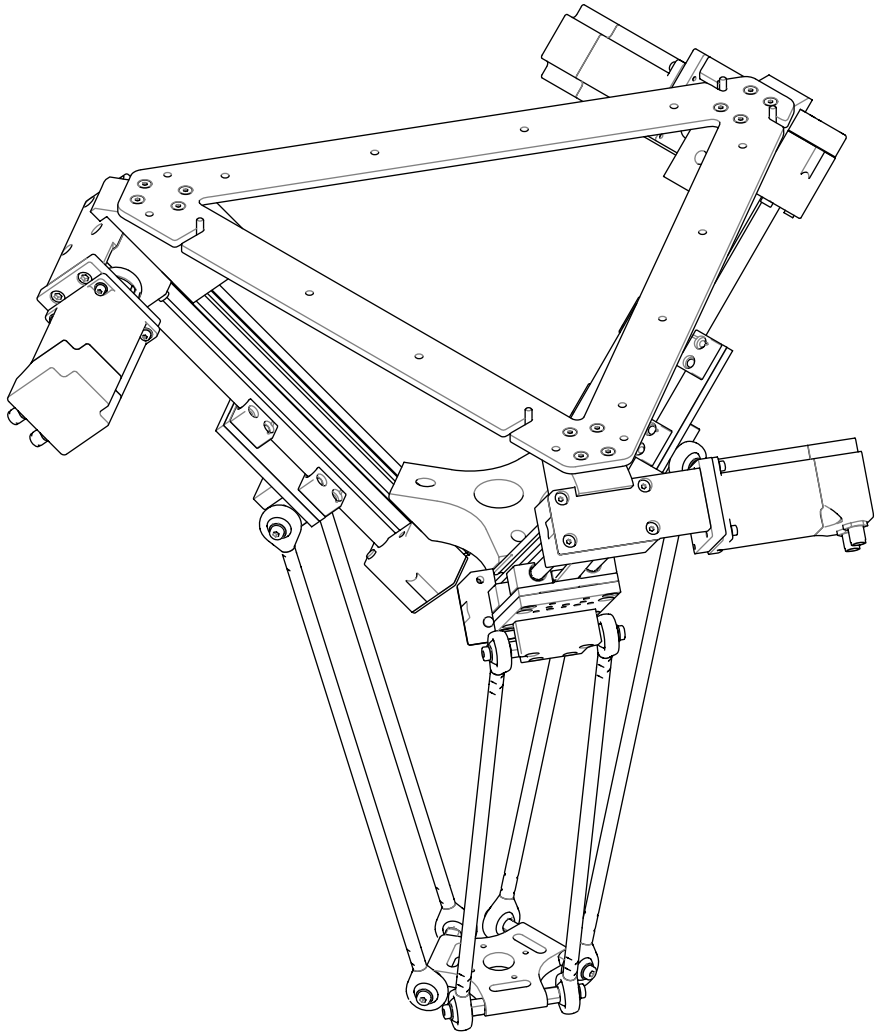

Technische Daten technical datas

Positioniergenauigkeit accuracy	+/- 0,5	[mm]
Arbeitsraumdurchmesser bei 75 [mm] working space diameter at 75 [mm]	360	[mm]
Max. Nutzlast max. payload	5	[kg]
Max. Prozesskraft bei Radius 0 [mm] max. process force 0 [mm]	100	[N]
Dynamik dynamics with 500 [g]	mind. 60 min. 60	Piks. (min) pics/min
Eigengewicht mass	15	[kg]
max. Bahngeschwindigkeit max. track speed	3	[m/s]
Max. Beschleunigung max. acceleration	60	[m/s ²]
Schrittmotor NEMA23 XL Stepper motor Nema 23 XL with	24/48 4,2	[V] [A]

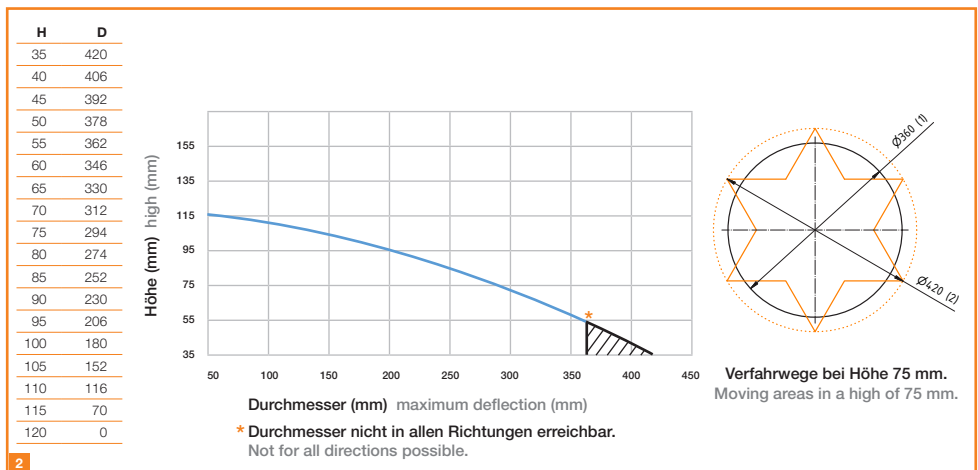
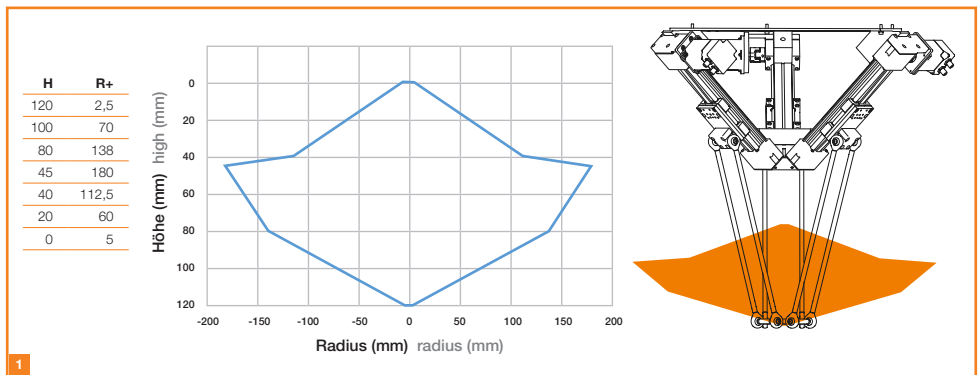



minimale Dynamik
minimum dynamics

Nutzlast in (g) mass in (g)	Dynamik in Piks/min dynamic in (pics/min)
100	45
250	40
500	35
1000	30
5000	15

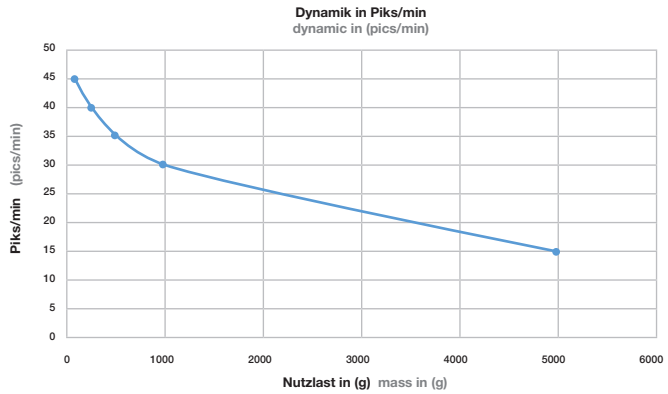

Höchste Pickraten können bei Verwendung von Master Steuerungen mit Bahnplanung erreicht werden. (Z.B. Sinus Beschleunigungsrampen und optimierte Motorregelparameter) Grafik gilt für Lastmotorspannung von 48 [V] und stabilen, schwingungssteifen Profil. You can get the highest (pics/min) by using a master controller with path planing function. (For example, Sinus acceleration ramp and optimized motor control parameters) Graphic as shown apply to a load motor voltage of 48 [V], to a stable and vibration-free frame.

3

minimale Lebensdauer

Nutzlast in (g) mass in (g)	Zyklusanzahl in mio. lifetime in millions cycle.
100	15
250	15
500	10
1000	5
5000	2,5

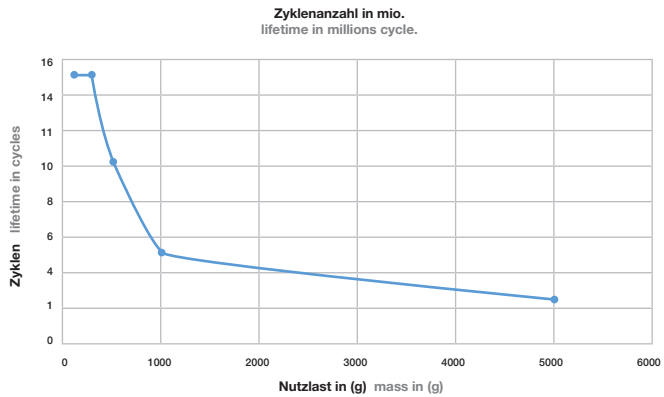

4



Anschlussmaße connecting dimensions

Artikelnummer ETY-DR-0008
article number

Beschreibung Aufnahmemestern mit Anschlussmaßen
description flange panel

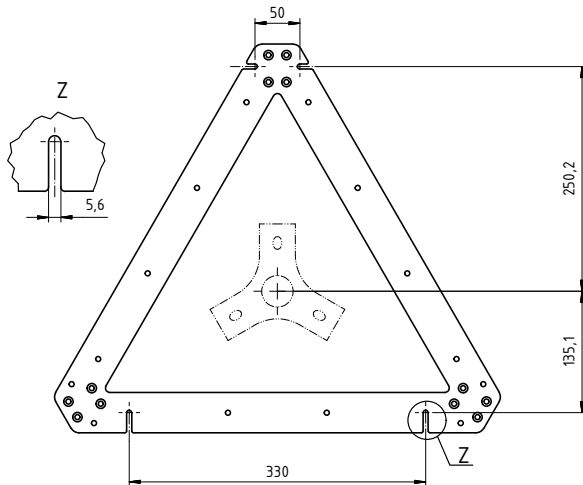

Artikelnummer ETY-DR-0009
article number

Beschreibung Aufnahmemestern mit Anschlussbohrungen für Zubehör
description flange star with drillings for other equipment

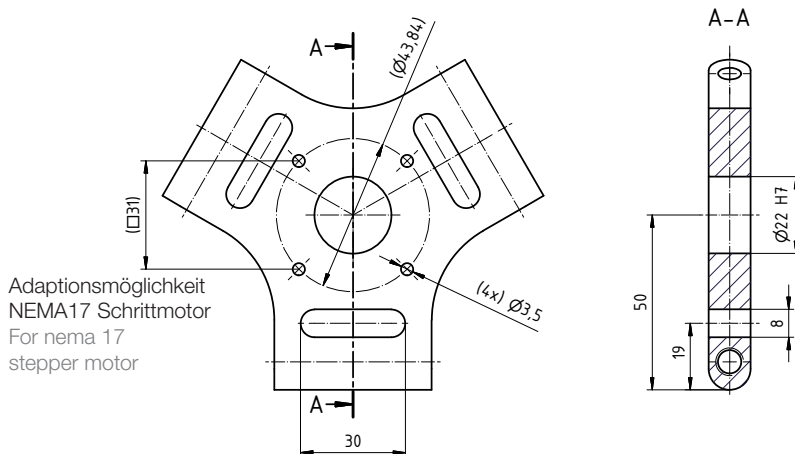

Zubehör accessories

Artikelnummer D1
article number

Beschreibung Dryve Steuerung D1, Motorsteuerung, Keine Softwareinstallation oder App nötig, für PC, Tablet oder Smartphone, Schritt-(ST), DC und EC Motoren mit bis zu 21A Spitzenströmen und 48 V DC, Digitale Ein-Ausgänge, Analoge Eingänge, CANopen, Modbus TCP zum Anschluss an Mastersteuerungen wie z.B. Siemens oder Beckhoff

Dryve motor controller D1, a motor controller for multi-fold automation tasks without programming by simple parameterization for single axes, linear, flat and room linear robots and Delta robots no software installation or app needed, use by PC, tablet or smart phone Stepper (ST), DC and EC motors with up to 21A peak currents and 48 V DC, digital inputs/outputs, analogue inputs, CANopen, Modbus TCP for connection to master control systems such as Siemens or Beckhoff



Artikelnummer IK-0001-BG-3, IK-0001-BG-5, IK-0001-BG-10
article number

Beschreibung Initiator kit, 24V, 0630/1040
description NC/Öffner, inkl. Leitung in 3, 5 oder 10 m.
initiator kit, 24V, 0630/1040
normally closed, with cable in 3, 5 or 10 meter



Artikelnummer AK-DR-0002
article number

Beschreibung Kalibrierdorn für einfache Positionierung
description Calibrating pin for easy positioning



Artikelnummer ETY-DR-0017
article number

Beschreibung Kabelclip für sichere Führung
description Cable clip for guidance





Artikelnummer article number	MOT-ST-28-L-C-A
Beschreibung description	Schrittmotor NEMA11,Mo=0.1, Spindelmotor mit Litzen und Encoder Datenblatt unter Spindelschrittmotoren: https://www.igus.de/info/drive-technology-drylin-e-faq-data-sheets steppermotor NEMA11,Mo=0.1, spindle motor/wires/encoder more information for spindle motors: https://www.igus.eu/info/drive-technology-drylin-e-faq-data-sheets

Leitungen cables

Artikelnummer article number	MAT9043737, MAT9043738, MAT9043740
Beschreibung description	Motorleitungen in 3, 5 und 10 m. motor cable in 3, 5 or 10 meter
Artikelnummer article number	MAT90432594-3, MAT90432594-5, MAT90432594-10
Beschreibung description	Encoderleitung für NEMA23 in 3, 5 or 10 m encoder cable in 3, 5 or 10 meter







Bausatz im Schaum
Assembly kit

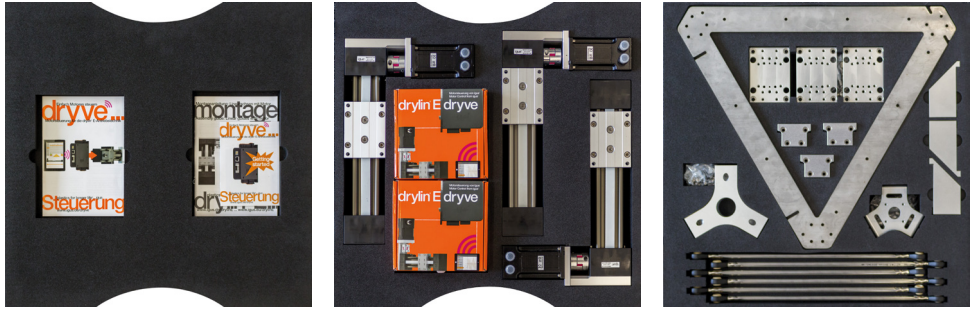

Montiert im Transportgestell
Assembled Delta, in transport rack

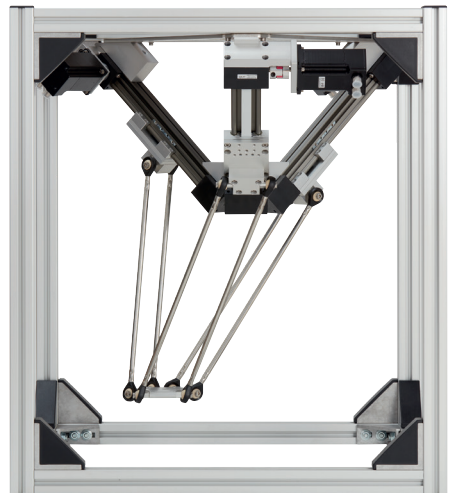
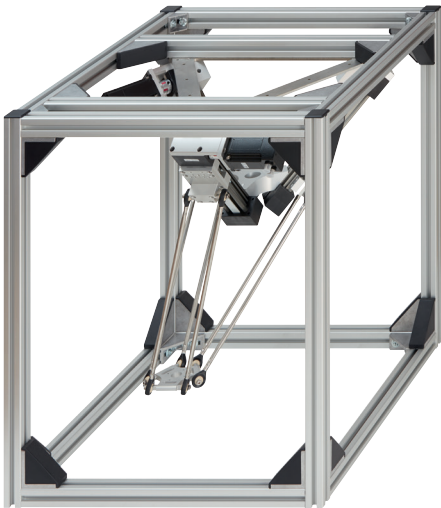

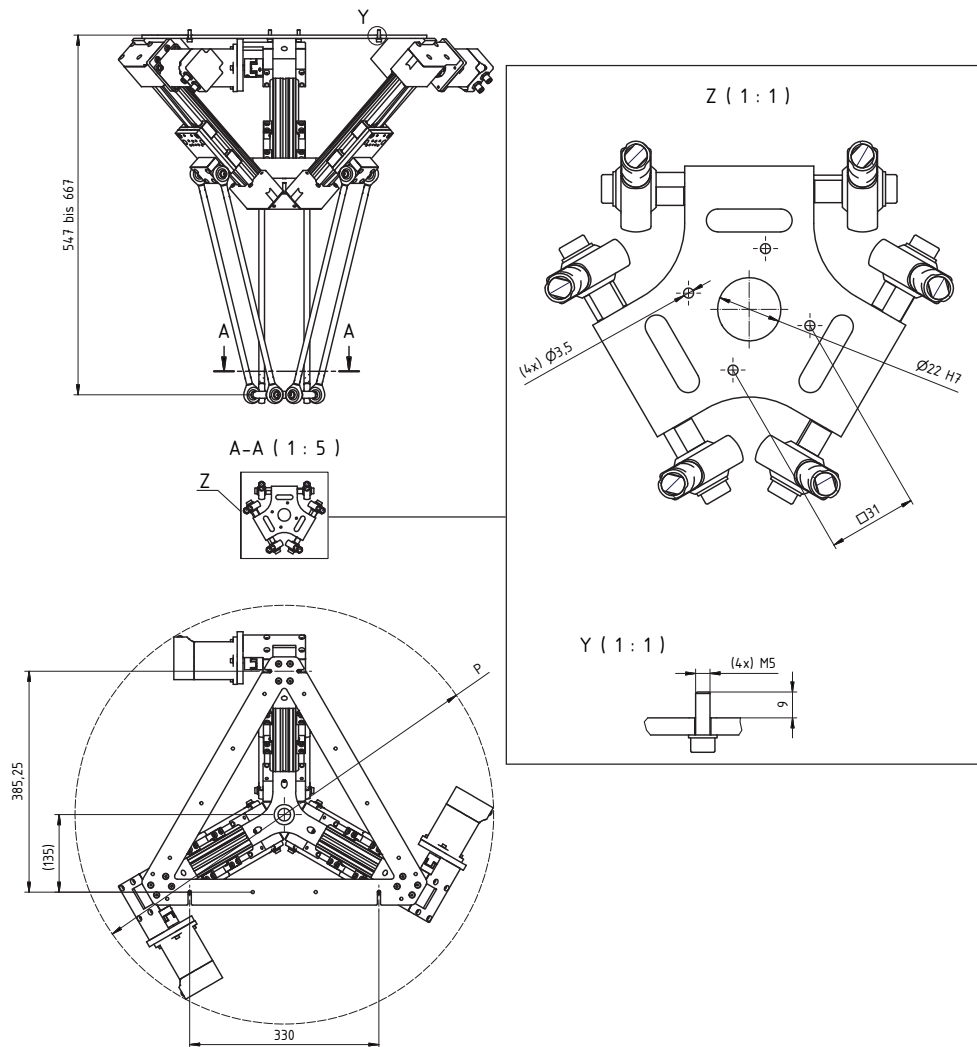

Artikelnummer Article number	Bausatz Assembly kit	Montiert Assembled	Steuerungen Controller	Motoren Motors	P = Platzbedarf Space requirement
DLE-DR-0001	●			●	730
DLE-DR-0002		●		●	730
DLE-DR-0003	●		●	●	730
DLE-DR-0004		●	●	●	730
DLE-DR-0005	●				645
DLE-DR-0006		●			645

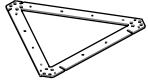

ETY-DR-0008

1x



ETY-DR-0011

1x



ETY-DR-0009

1x

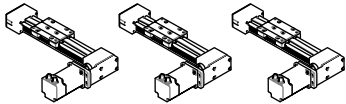

DL-ZLW-0264

3x

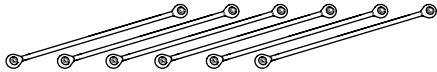

KDGM-10-A-ER-J

6x

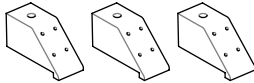

ETY-DR-0013

3x

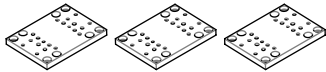

ZWY-104001

3x

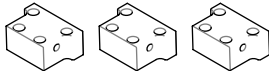

ETY-DR-0010

3x

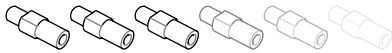

ETY-DR-0012

12x

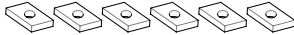

NOR-20602

20/12-M5

6x



NOR-11030

6x12x1

12x



NOR-11013

M5, A2

4x

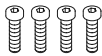

NOR-10513

M5X16

4x

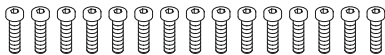

NOR-10514

M5x20

15x



NOR-10610

M5x12

3x



NOR-10628

M5x12

12x



NOR-10629

M6x20

12x



NOR-10737

M5x14-A2

12x

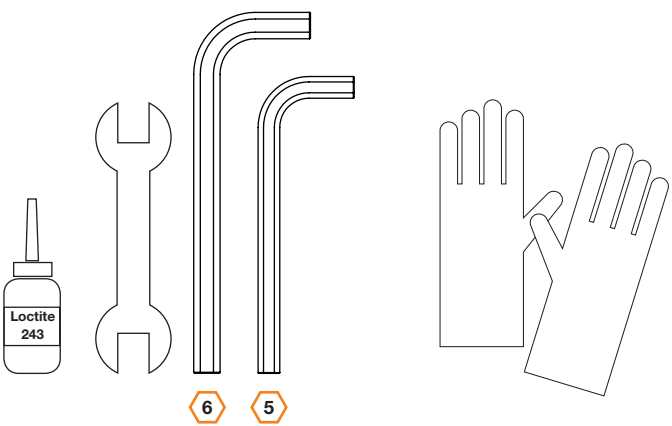
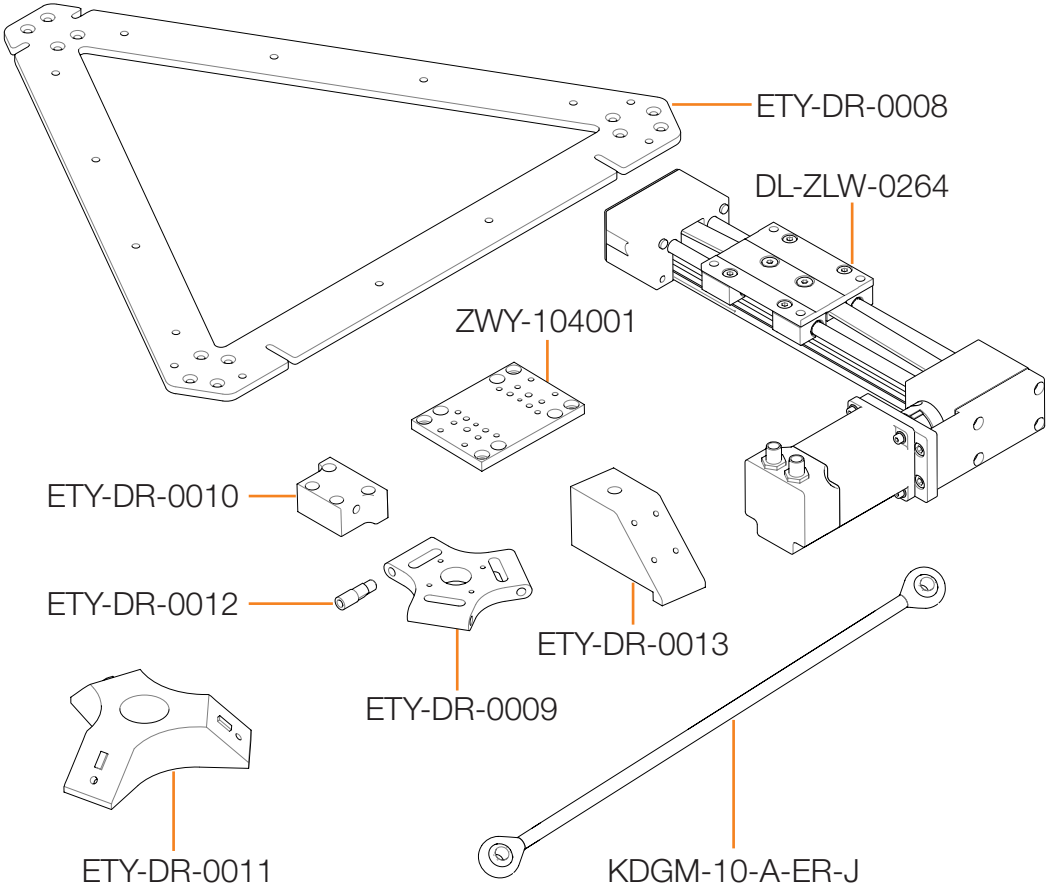

1

3x

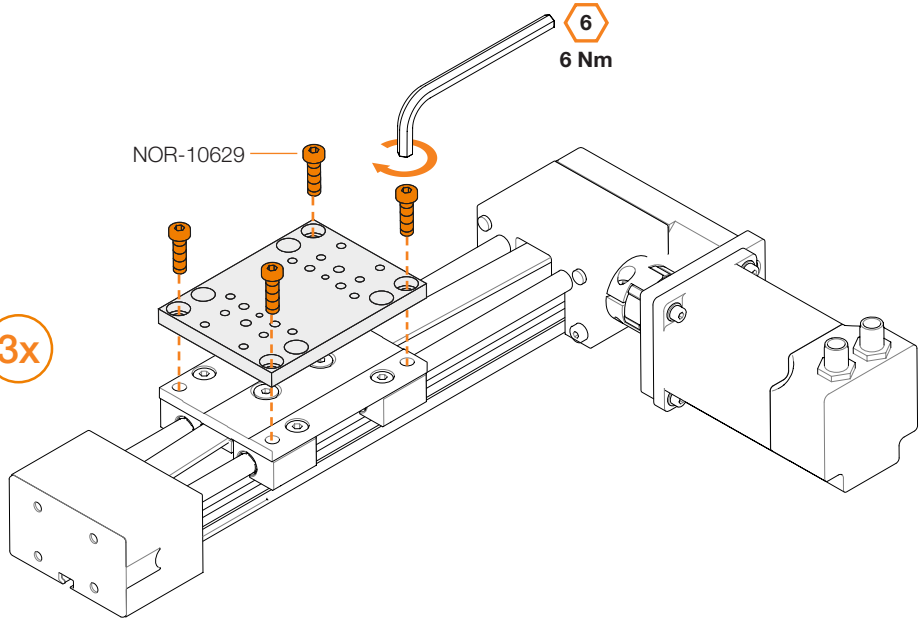

2

3x

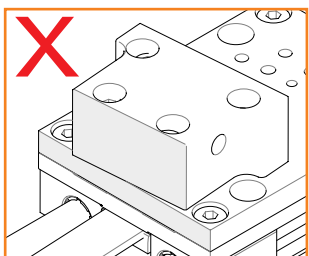
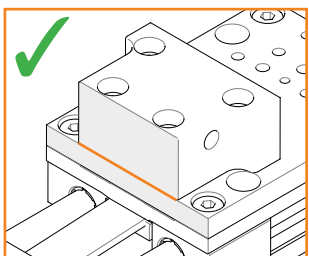
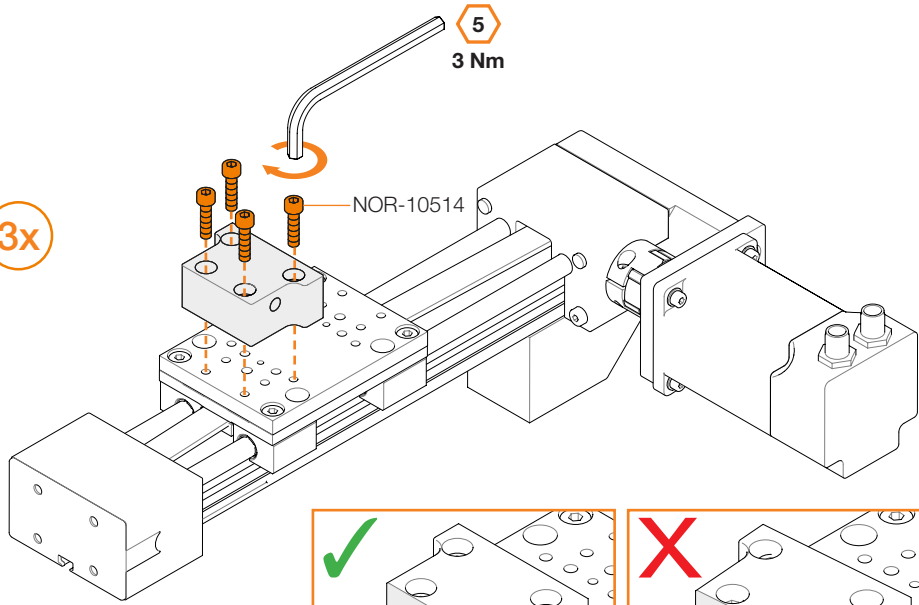

3

3x

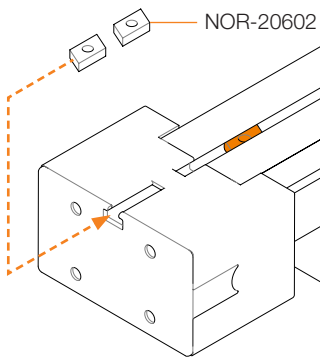

4

3x

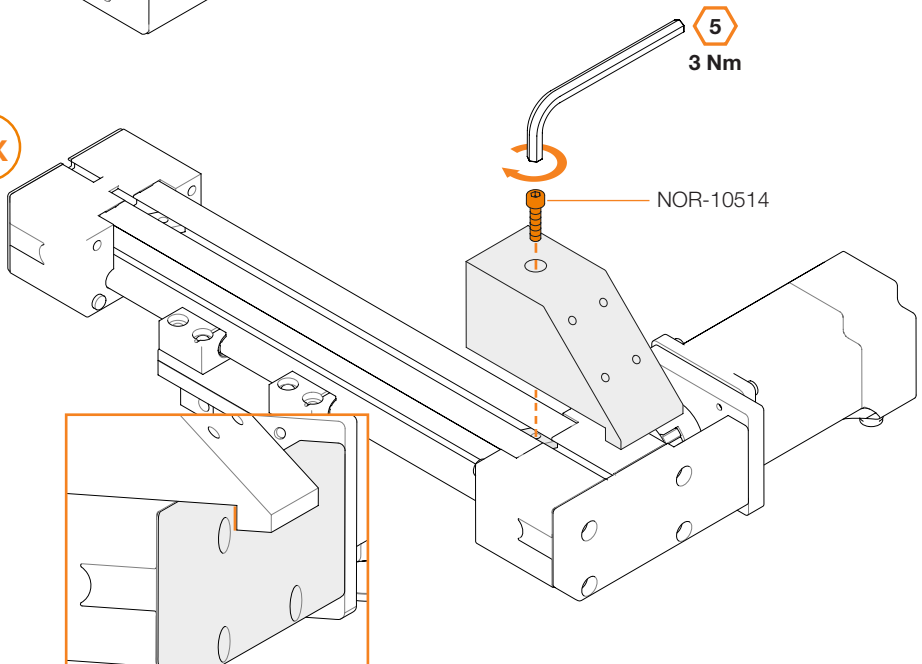

5

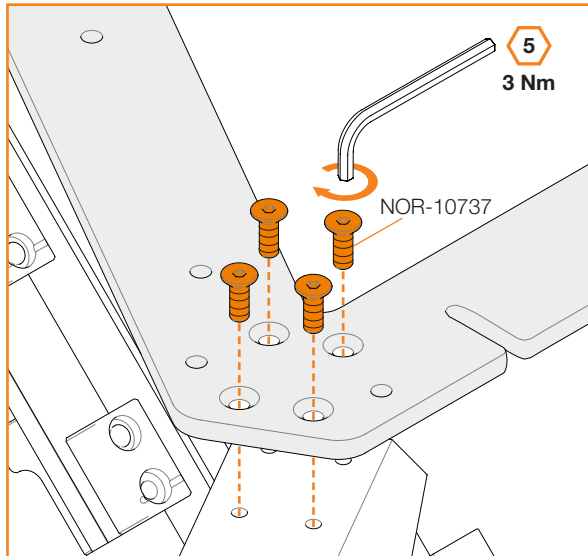
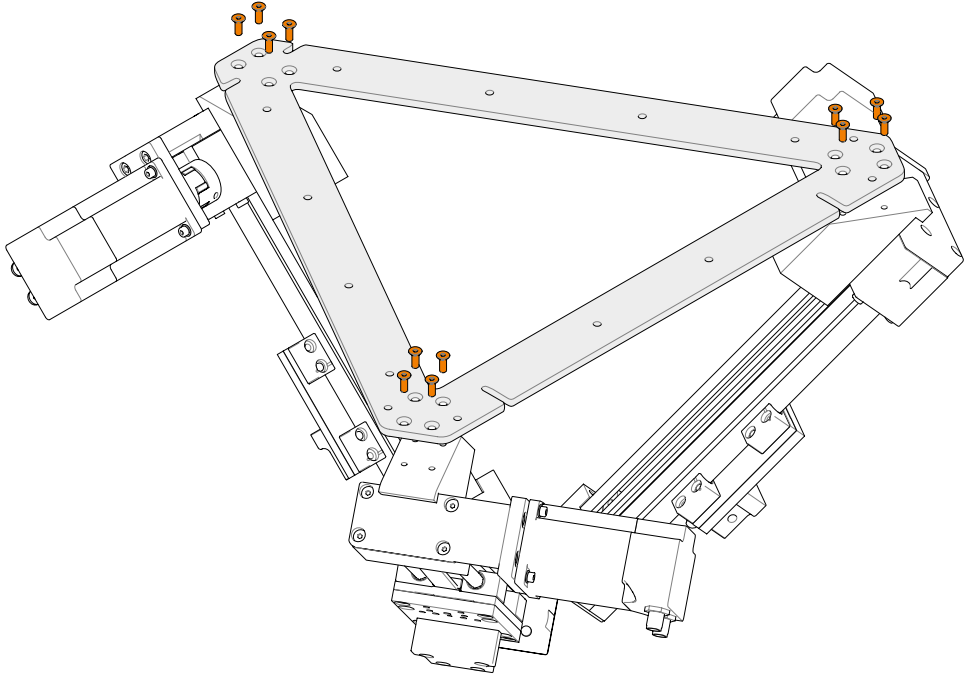

6

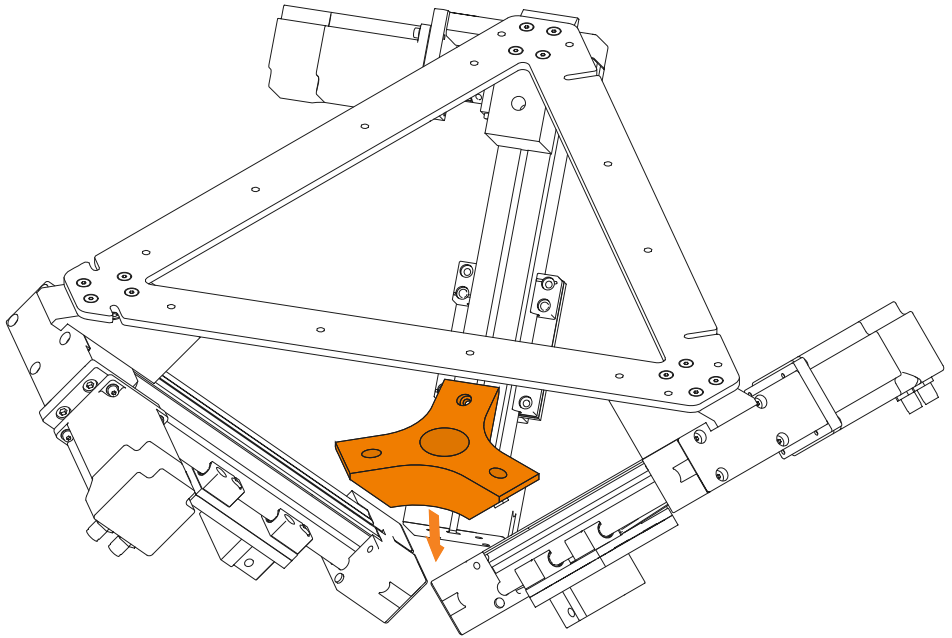

7

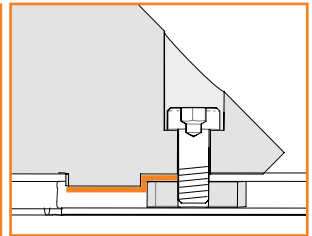
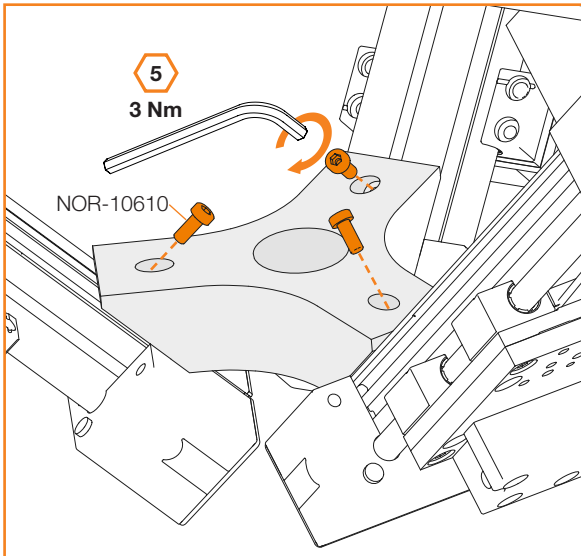

8

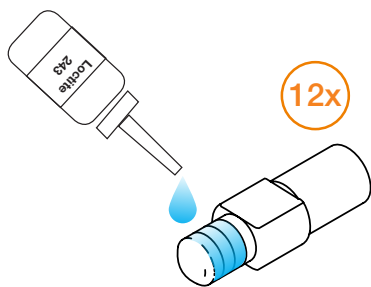

9

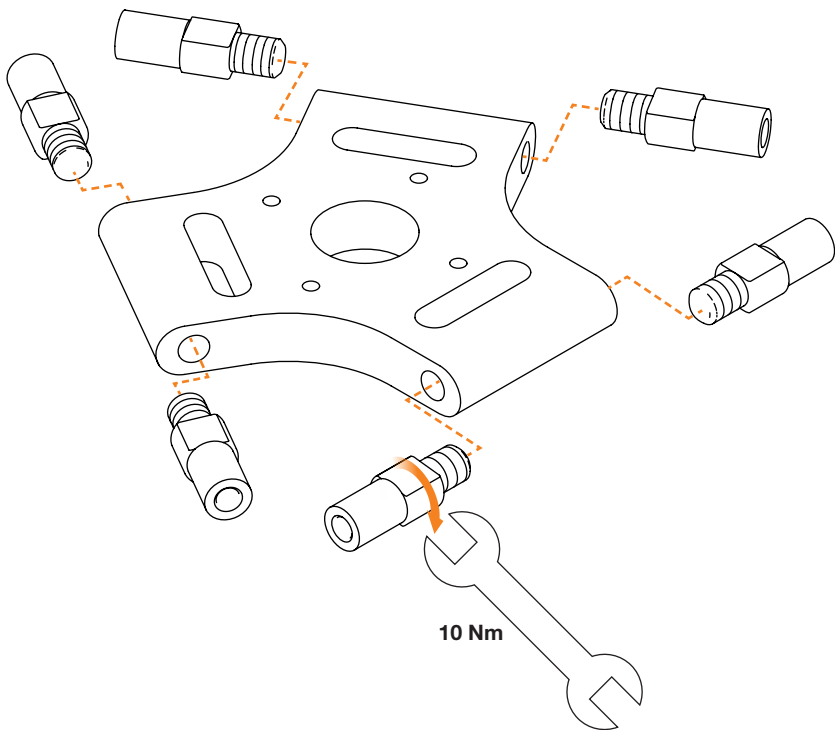

10

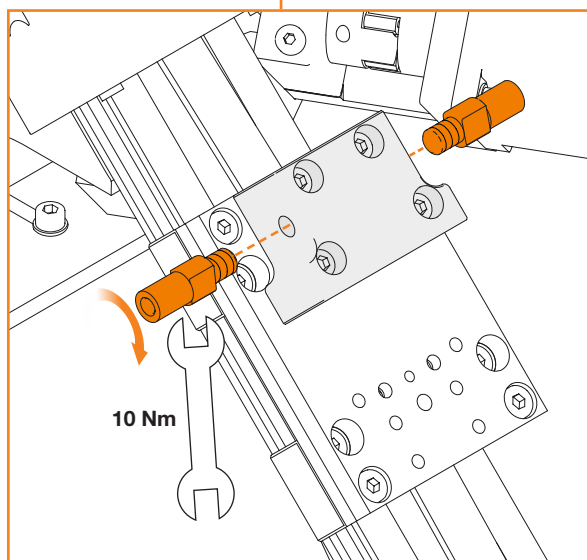
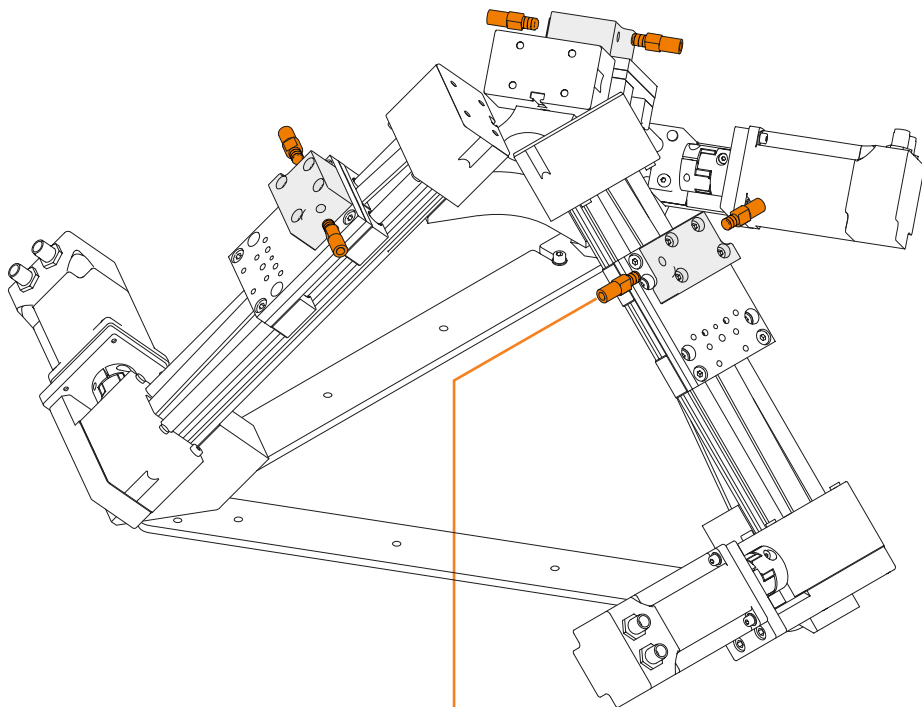

11

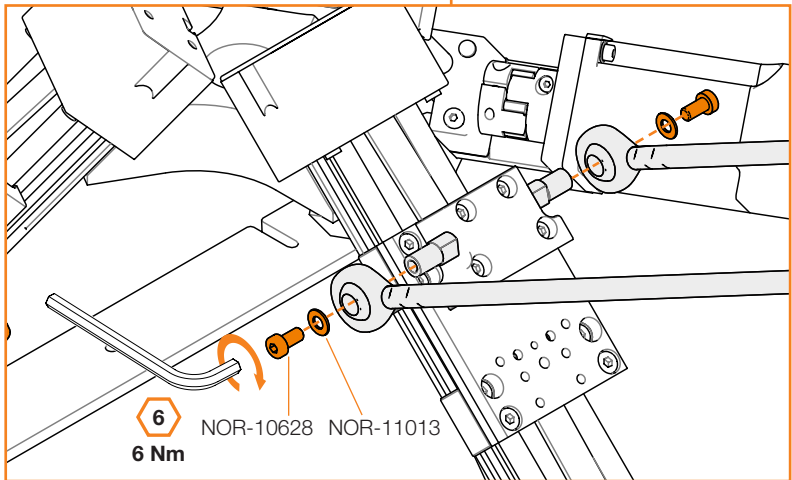
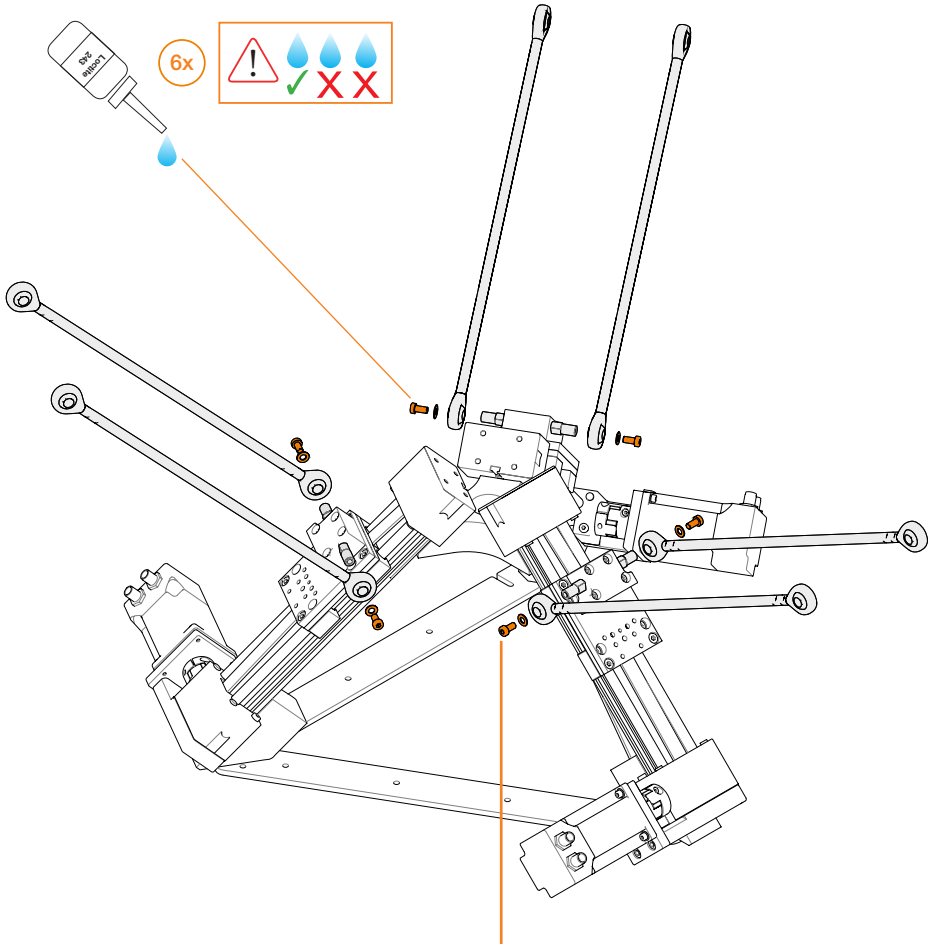

12

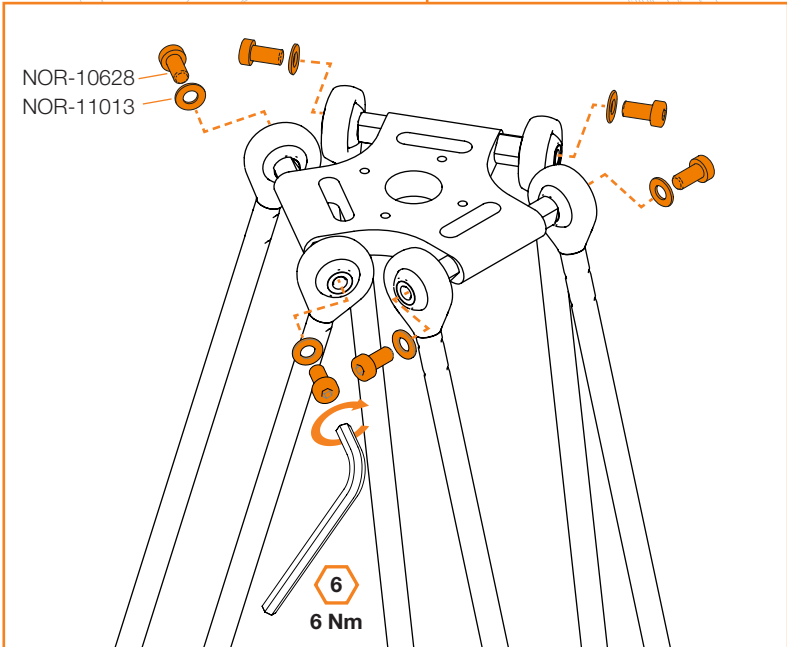
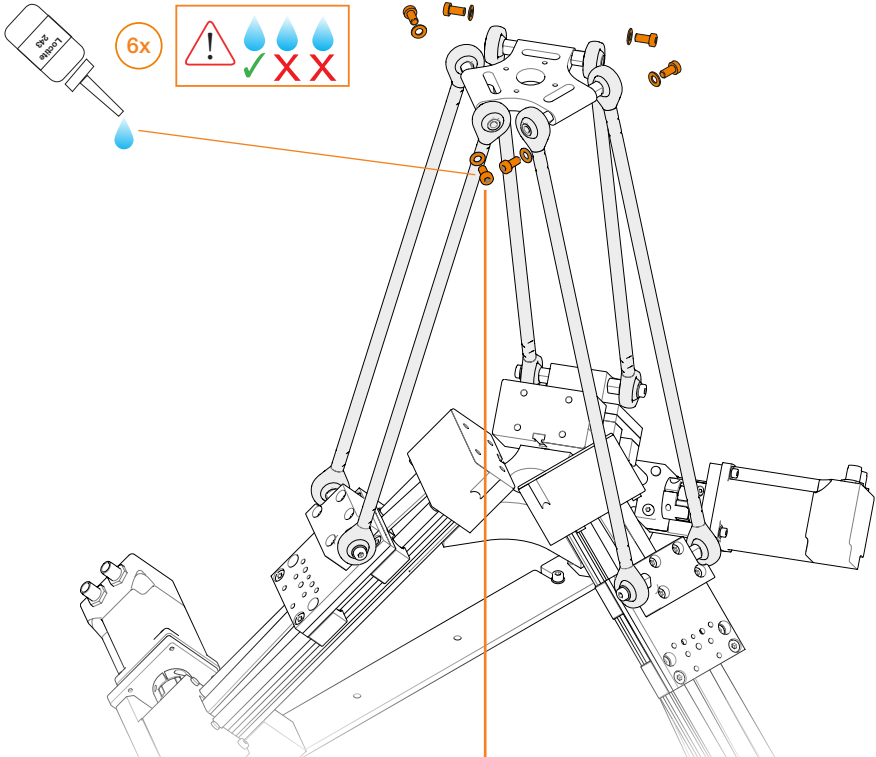

13

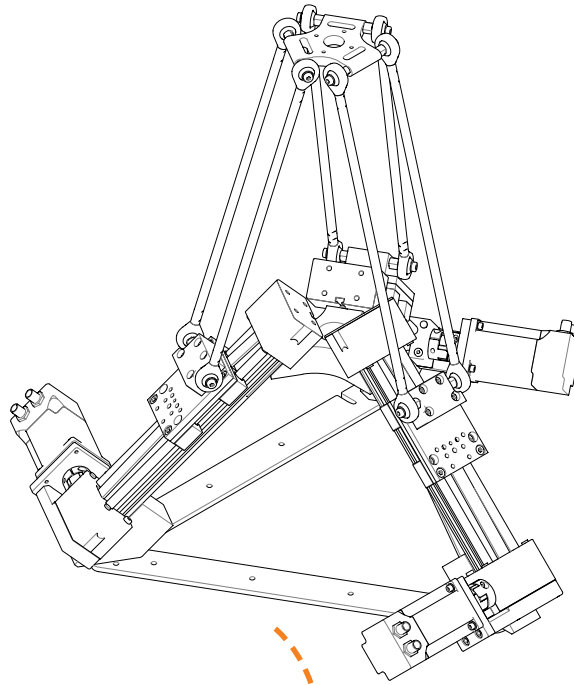

180°

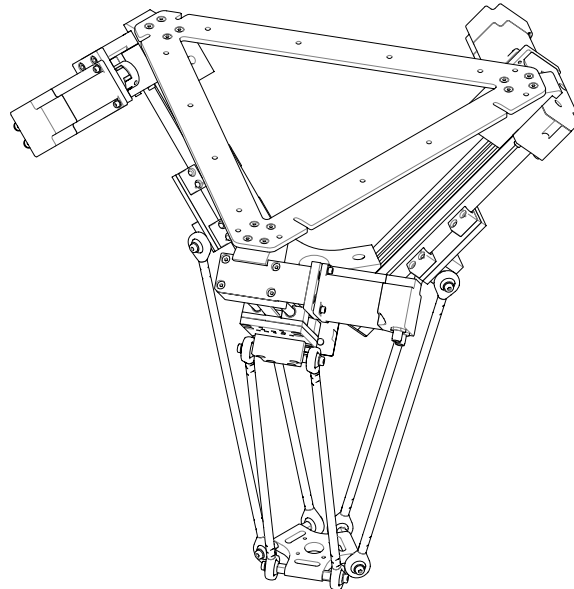

14

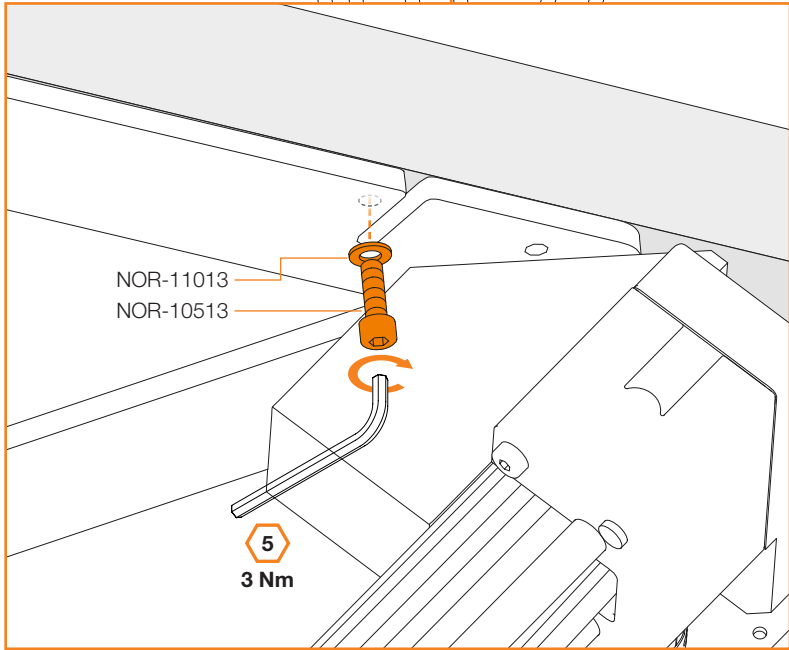
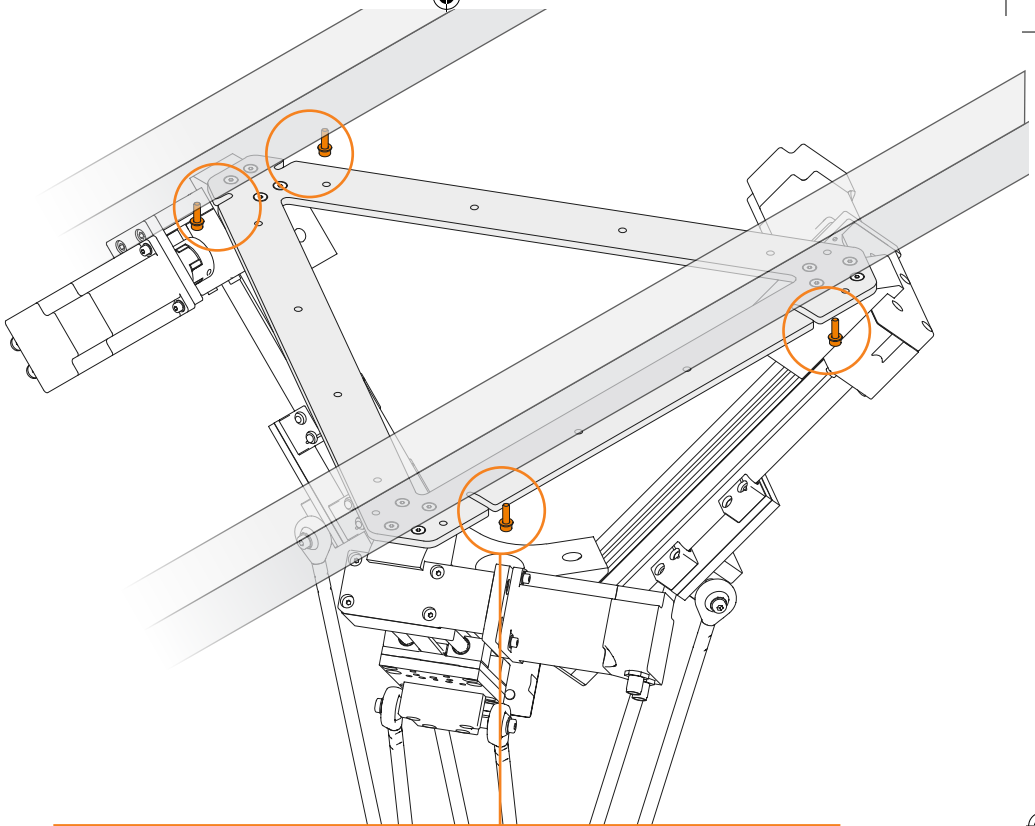

15

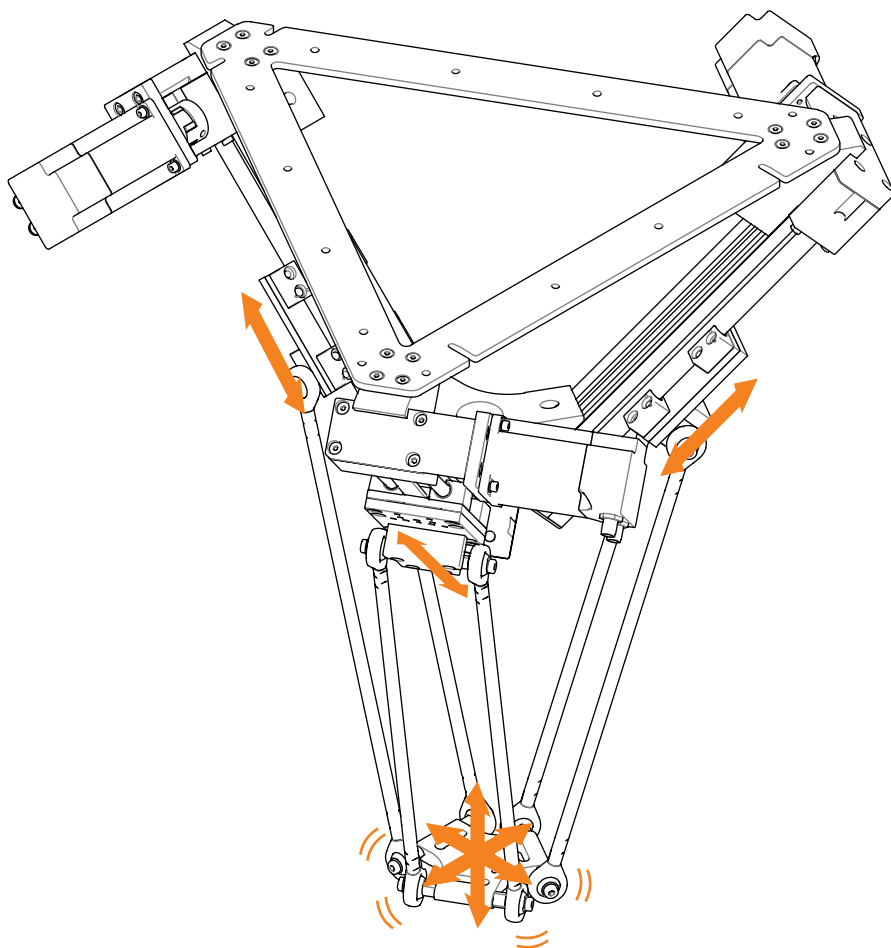



iglus® GmbH
Spicher Str. 1a
51147 Köln Cologne
Tel. +49 2203 9649-145
Fax +49 2203 9649-334
info@iglus.de
www.iglus.de
www.iglus.eu

© iglus® GmbH

Herausgeber ist die iglus® GmbH, Deutschland
Published by iglus® GmbH, Germany
MAT0074228.25 Stand Issue 01/2019
Technische Änderungen vorbehalten
Subject to technical alterations